



TECHNICAL RIDER

Sound system must be completely installed and checked on time to start the sound check, at least one hour before the concert.

FOH MIXER

Digital mixer: MIDAS / SOUNDCRAFT Vi / DIGIDESIGN VENUE

MONITORS

- 7 monitors, 7 independent mixes

BACKLINE

- Electric Bass Amplifier 100w - 150w (Aguilar, Ampeg, Hartke)
- 1 base for Hi Hat
- 4 cymbal bases

ACCESSORIES

- 2 rectangular tables
- 1 chair
- 3 music stands



INPUT LIST

CHANNEL	INSTRUMENT	MIC
1	Voice 1	Beta 58
2	Voice 2 Lead	Beta 58
3	Voice 3	Beta 58
4	Voice 4	Beta 58
5	Voice 5	Beta 58
6	Voice 6 (MC)	Beta 58
7	Electroacoustic Guitar	Direct Box
8	Electroacoustic Charango	Direct Box
9	Electric Bass	Direct Box
10	Bass amp.	Beta 52
11	Bass Drum 1	Beta 52
12	Cymbal	SM 81
13	Bar Shimes	SM 81
14	Bass Drum 2	Beta 52
15	Snare	SM 57
16	Peruvian Cajon	SM 57
17	OH Left	SM 81
18	OH Right	SM 81
19	Hi-hat	SM 81
20	Minor Percussion	SM 81

STAGE PLOT

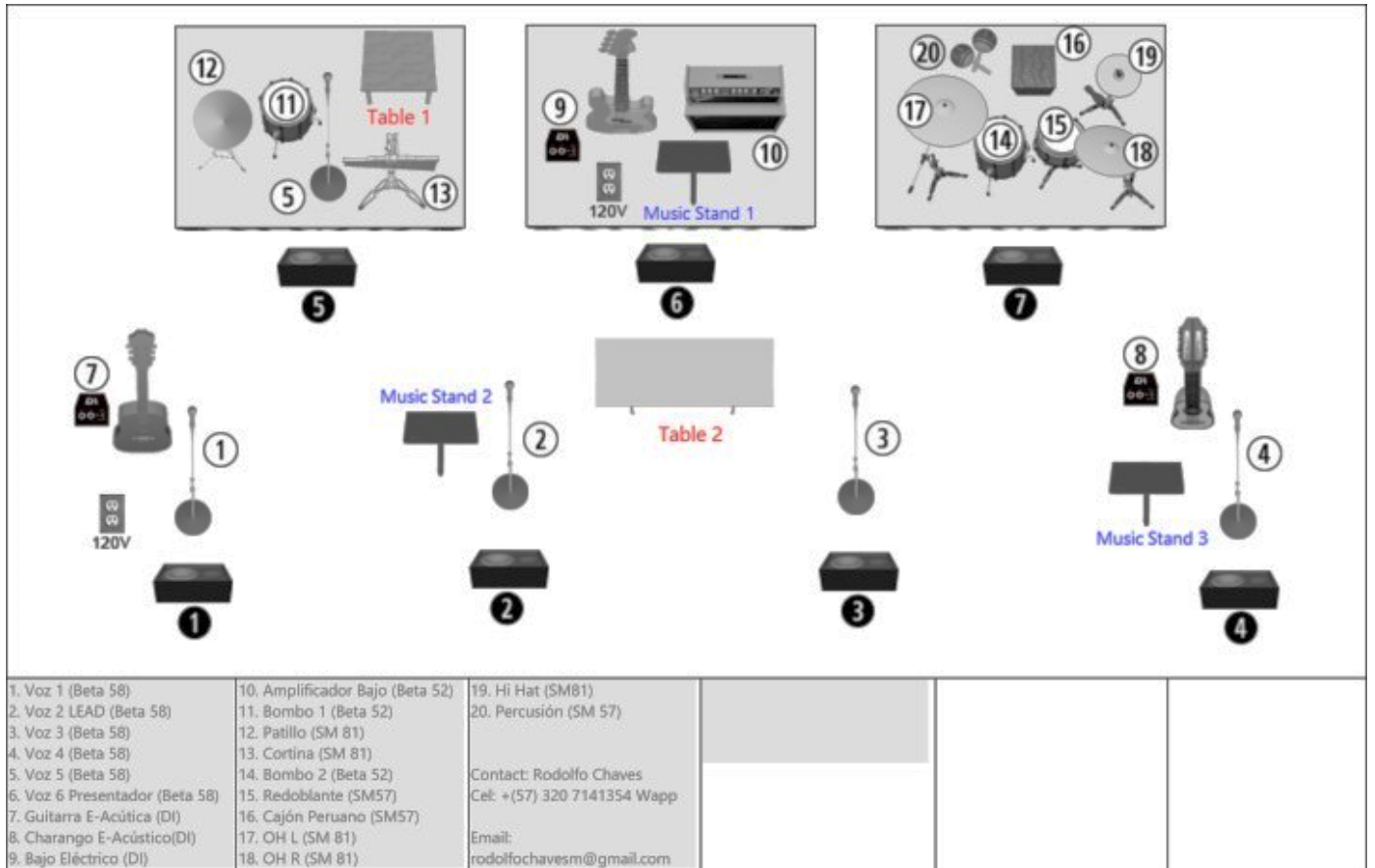

CONTACT

Rodolfo Chaves

Phone: (+57) 3207141354

Email: rodolfochavesm@gmail.com